

**Heath Road  
Twickenham  
TW1 4BN**

**£389,950**

**ChaseBuchanan**



- Viewings accompanied by Chase Buchanan
- Central Twickenham location
- Two double bedrooms
- Low outgoings
- First floor apartment
- Recently modernised
- Long lease
- Council Tax Band D

This very well presented, first floor apartment is situated in a highly convenient location on the high street, close to both Twickenham Green and Twickenham station.

Recently refurbished, the larger than average accommodation provides an open plan living room/fitted kitchen, two double bedrooms and modern bathroom.

Heath Road is ideally located to take advantage of all that Twickenham has to offer, from the range of boutique shops in Church Street, ambient restaurants and delightful riverside pubs and walks. Situated within a pleasant walk to Marble Hill Gardens along the riverside and within easy access of both Richmond and Kingston with comprehensive amenities. Commuter links are excellent with Twickenham station providing good links to London Waterloo, frequent bus routes and easy access to the M3 and M25 motorways and Heathrow Airport.

Lease 125 years. Ground Rent £150 pa. Service Charge Nil. (All details concerning the terms of the lease and outgoings are subject to verification).

EPC Rating – D

For more information or to book a viewing, please contact:

020 8744 0101

**ChaseBuchanan**

4 York Street, Twickenham, TW1 3LD

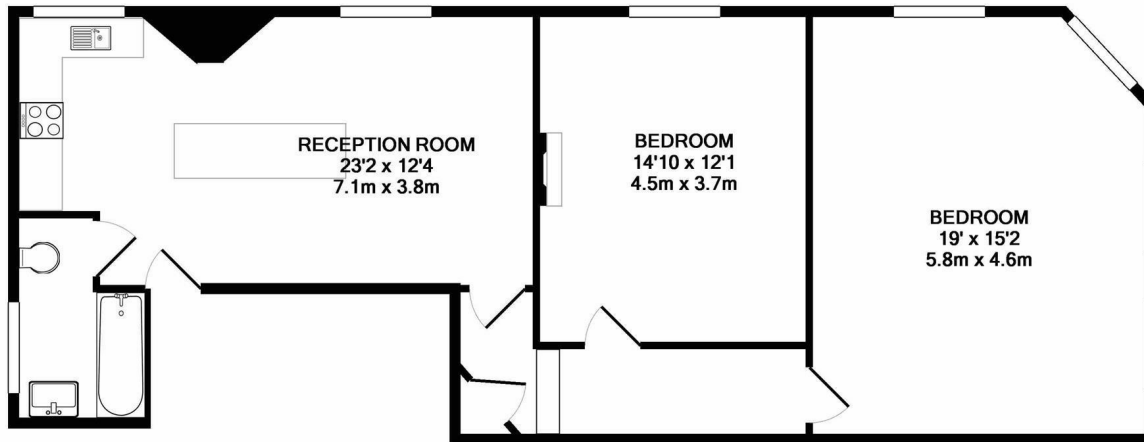

TOTAL APPROX. FLOOR AREA 892 SQ.FT. (82.9 SQ.M.)

Produced solely for Chase Buchanan  
Made with Metropix ©2019

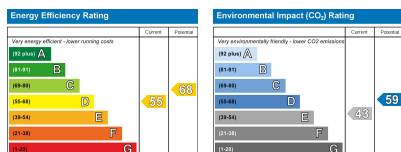

Care has been taken in the preparation of these particulars, however, their accuracy is not guaranteed and they do not form part of any contract. Measurements stated must be considered maximum.